

N<sup>o</sup> 94.

N<sup>o</sup> 2230.

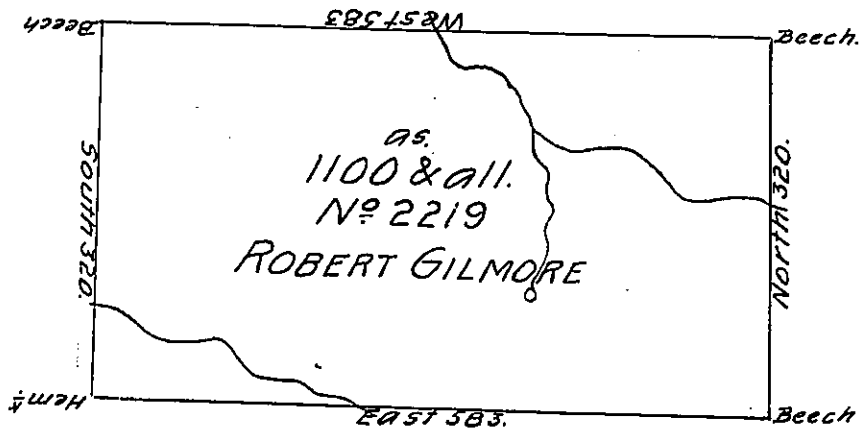

N<sup>o</sup> 2215.

Situate three Miles South of the State Line and about two Miles East of the Alleg-  
 aney River in North<sup>d</sup> County containing 11.00 acres and the usual allowance for  
 Roads &c. Surveyed June 18<sup>th</sup> 1793 for Robert Gilmore in persewance of a  
 Warrant N<sup>o</sup> 2219 bearing date-12<sup>th</sup> December 1792.

John Canan D.S.

Daniel Brodhead Esq<sup>r</sup> S.G.

IN TESTIMONY that the above is a copy of the original remaining on file in  
 the Department of Internal Affairs of Pennsylvania, made  
 conformably to an Act of Assembly approved the 16th day of  
 February, 1833, I have hereunto set my Hand and caused  
 the Seal of said Department to be affixed at Harrisburg,  
 this first day of November 1904.

*Loac R Brown*  
 Secretary of Internal Affairs.